

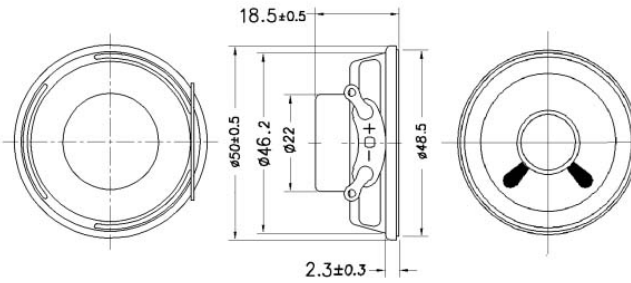

Model Number : LF-K50B18C
 Nominal Impedance : $8 \Omega \pm 15\%$
 Resonant frequency (F0) : 190Hz $\pm 20\%$
 Effective Freq. Range : Fo ~ 20KHz
 Sound Pressure Level (dB) : $86 \pm 3\text{dB} / 50\text{cm}$
 Input Power (Nom. / Max.) : 2.0W / 3.0W
 Distortion : 5%max. at 1KHz
 Operating Temp range : $-20 \text{ }^\circ\text{C} \sim +60 \text{ }^\circ\text{C}$

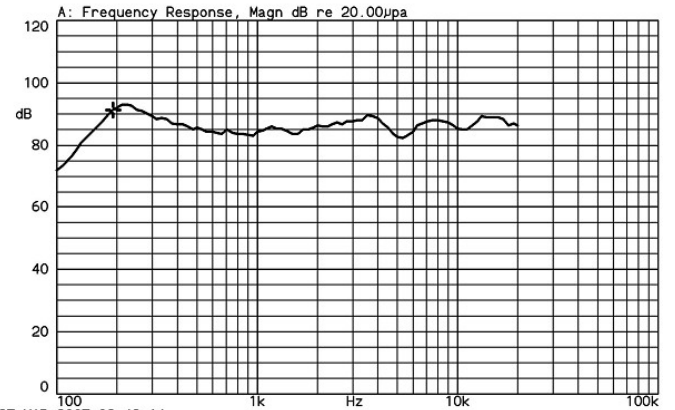

LF-K50B18C 2.83Vrms by IEC268-5 1/2 std baffle 50cm
 X:190.00Hz *Y:91.12dB ZA:Live Curve SSR Fund.



27-MAR-2007 09:42:14

Mode: SSR

