

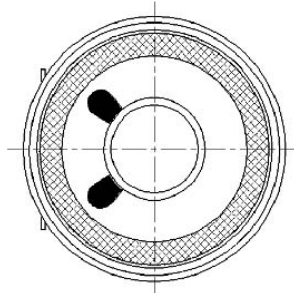

Model Number : LF-K36A12A
 Nominal Impedance : $4 \Omega \pm 15\%$
 Resonant frequency (F0) : $330\text{Hz} \pm 20\%$
 Effective Freq. Range : $F_0 \sim 20\text{KHz}$
 Sound Pressure Level (dB) : $86 \pm 3\text{dB} / 50\text{cm}$
 Input Power (Nom. / Max.) : $4.0\text{W} / 6.0\text{W}$
 Distortion : $5\%\text{max. at } 1\text{KHz}$
 Operating Temp range : $-20 \text{ }^\circ\text{C} \sim +60 \text{ }^\circ\text{C}$

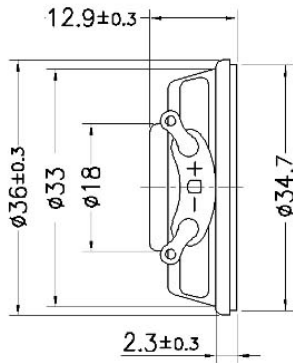

K36A12A 2Vrms by IEC268-5 1/2 std. baffle 50cm
 X:315.00Hz *Y:88.82dB ZA:Live Curve SSR Fund.

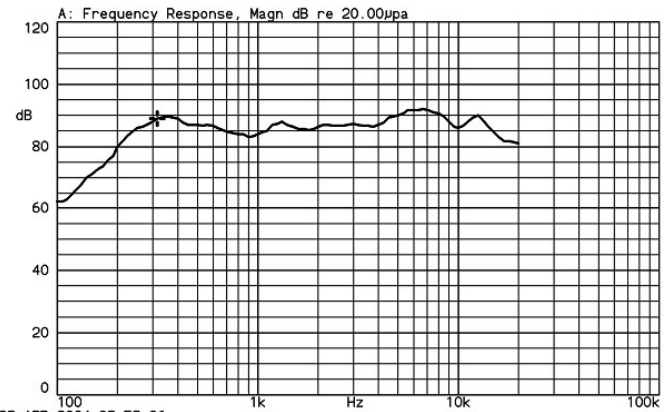

28-APR-2004 08:58:06

Mode: SSR

