

Model Number : LF-K15B39A
 Nominal Impedance : $8 \Omega \pm 15\%$
 Resonant frequency (F0) : $1000\text{Hz} \pm 20\%$
 Effective Freq. Range : $F_0 \sim 20\text{KHz}$
 Sound Pressure Level (dB) : $93 \pm 3\text{dB} / 10\text{cm}$
 Input Power (Nom. / Max.) : $0.75\text{W} / 1.0\text{W}$
 Distortion : $5\%\text{max. at } 1\text{KHz}$
 Operating Temp range : $-25 \text{ }^\circ\text{C} \sim +60 \text{ }^\circ\text{C}$

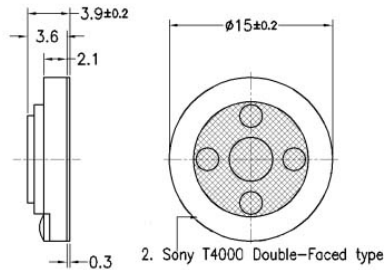

LF-K15B39A-B 2.45Vrms by IEC268-5 1/2 std baffle 10cm
 X:1.0000kHz *Y:99.63dB ZA:Live Curve SSR Fund.

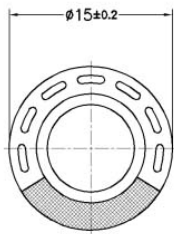